

SacheenSCOPE

Spring 2024

Published by the Sacheen Lake Association
Interim Editor: Grant Miller

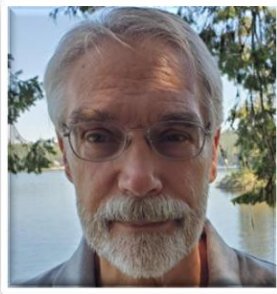

President's Message: It has been a long road, but I think the SLA is now in the 21st century! (Before now, we had our foot and then some in the door, but not 100% through the door!) These last two years we have spent a significant amount of effort increasing our digital footprint consisting of website updates for the SLA and Sacheen Water and Sewer District, digitizing our merchandise program, adding two new emails for better community interface, documenting SLA operating guidelines for consistency across SLA Board member changes, and updating the SLA By-laws consistent with how we operate. I appreciate all the efforts of the SLA Support Staff and Board members for making this come

to fruition. We've also added a few more community involvement contests to the great satisfaction of the entrants and the Board members who have the privilege of judging their lake-life stories and voting on their favorite photo calendar contest entries. From what some of our community members have indicated, they have appreciated the efforts undertaken. And now I am happy to say, we may kick back a little this summer and enjoy our lake life with our now fundamentally stable SLA changes. However, we welcome comments from our SLA members and lake community to help us help you shape your experiences at Sacheen Lake. Please drop us a line at SacheenLake.Assoc@gmail.com with your ideas, concerns, and accolades (who doesn't like a pat on the back?). We hope this summer season brings you plenty of warm days, fun on the lake and the ability to share our beautiful lake gift with family and friends.

- Grant Miller, President Sacheen Lake Association

Search for Two New SLA Board Members

The SLA is looking to fill two Board of Director slots. We had one Board member resign, Elaine Hooker, due to her new workload. Elaine will continue to support the SLA as the lead for the Merchandise Program. Thank you, Elaine, for both your past and future support! We also had two new members join: Anthony Patterson and Carl Gross. But we still have two openings to fill our 11 seat Board. Those interested in being on the SLA Board, please contact the President via email at SacheenLake.Assoc@gmail.com. Grant will connect with you and walk you through the requirements for Board membership and, if you're still interested, he'll interview you so you can ask questions and discuss your interest in being a Board member. Please consider volunteering to help your lake and community through applying for a position on the SLA Board. Thank you!

SacheenSCOPE Editor

Once again the SLA needs an Editor for the SacheenSCOPE. We are looking for someone willing to research topics of interest to the community, coordinate and format input from the SLA, and coordinate with outside organizations such as the Sheriff's Department, South Pend Oreille Fire and Rescue, and the Sacheen Water and Sewer District to collect relevant information for adding to the SacheenSCOPE. We produce the SCOPE about three times a year. If you have interest in being our next Editor, please contact Grant at SacheenLake.Assoc@gmail.com.

Sacheen Lake Association Membership and Contact Form

Dues for 2024 are \$5 Student, \$10 for an Individual, \$25 Family, \$100 Sustaining

Please fill out this form and mail it with your check, payable to:

Sacheen Lake Association, c/o Denise Reilly, Treasurer

P.O. Box 401, Newport, WA 99156-0401

PLEASE include your correct CURRENT EMAIL ADDRESS and PHONE #

Name:	
Mailing Address:	
Lake Address:	
Phone:	
Email Address:	<i>If you do not have an email address enter NONE</i>
Membership type:	<i>Check only one</i> <input type="checkbox"/> Individual <input type="checkbox"/> Family <input type="checkbox"/> Public/Not for Profit <input type="checkbox"/> Student <input type="checkbox"/> Sustaining (contributes more dues than required)

Please let us know who and where you are on the lake as well as how to reach you



Community Planning

The Pend Oreille County (POC) Development Department finalized an update to the POC Comprehensive Plan on 6 Feb 2023. This plan defines concepts for growth in POC. Sacheen Lake is identified as one of the more populated rural areas with county services (specifically the Water and Sewer District's sewer system) for possible future development. The SLA sent a letter via email and USPS to Greg Snow, Director, Community Development Department requesting that the SLA be identified as an "interested party." Mr. Snow has replied by email assuring this would be the case and he'd inform us of Sacheen sub-area planning activity. Specifically, Mr. Snow indicated the following: "Thank you for your interest in a potential Sacheen Lake Sub-area Plan. At this time there is no timetable for beginning that plan. It has been listed in the Comprehensive Plan as a possible location since its inception in 2006, however, physical conditions don't currently warrant the development of a plan in your location. Additionally, the current zoning reflects the ability to allow commercial uses near the intersection of Highway 211 and Fertile Valley Rd where commercial businesses are already located." Due to the SLA's By-laws documented Mission Statement and Goals regarding the ecosystem and rural nature of our community, the SLA will continue to gain an understanding of the planning process and keep the community informed as best we can. We plan to have a guest speaker at the Saturday, 15 June 2024 SLA Annual Meeting to discuss some history of the Comprehensive Plan update, possible impacts to the Sacheen Lake area, and how to best be involved in the process.



Community Survey Regarding Myers/Harter Sanctuary

The Sacheen Water and Sewer District (W&SD) asked the Sacheen Lake Association (SLA) to consider leasing the Myers/Harter Sanctuary (park) as a means to reduce financial responsibility to the W&SD to management / maintain the park (my understanding of the purpose for their request). The SLA Board had multiple discussions on the feasibility of leasing the park starting in October 2023 and ending this winter. Early in our discussions, the SLA had several key concerns: (1) manpower to manage the park and (2) ability to be financially responsible. In our discussions, the SLA Board felt that both of these key concerns would need to be strongly, if not 100%, supported by the community. The SLA Board members are not paid and some are still working full time, thus an additional workload on our Board activities was not feasible. Additionally, the SLA's annual income and expenses are essentially flat in net gain (loss); to pay for park maintenance, the SLA would need an influx of new funds.

The SLA Board rapidly concluded that we would need support from the community to lease the park. We, therefore, sent a survey to the community on 14 November 2023 in the form of questions aimed at understanding how much of the community uses the park and would people be willing to support it through volunteer efforts and/or donations. The questions were:

1. How many times a year do you go to the park, other than the SLA Annual Picnic?
2. When you go to the park, how do you use the park? For example, for walks, conversation with friends, or use of the space for athletic endeavors (e.g., the volleyball court).
3. Would you like to see improvements to the park and if so, of what nature?
4. Do you think improvements would increase your use of the park?
5. If the maintenance of the park becomes a community cost, what are you willing to pay on an annual basis?
6. Would you volunteer to help maintain the park (never, 2 times a year, on a semi-regular basis such as locking/unlocking the gate daily during the open season and on a rotating basis)?

The survey results were sent to the community on 1 February 2024 and provided below.

- 44 responses representing at least 68 people (some said “family” w/o a number). That represents about 10% of the addresses in the Sacheen W&SD.
- 72% of responses said they don't use the park.
- If used, uses were: walk, talk, volleyball, kayak to park, restroom, be outdoors.
- Improvements desired: water access, dock, swimming, pickleball court, basketball, tennis, renewal of plant identification placards and benches, play structure for kids.
 - 32% gave a response here. 9% for pickleball, 18% for dock, 5% water access.
- Would improvements increase your use of the park: 71% said no.
- Would you contribute to the park maintenance cost?
 - 60% said no (or give \$0)
 - 27% gave a specific value. That average was \$31.42 (one outlier drove this up). Estimate \$377 / year of support if asked voluntarily.
- Would volunteer to help at the park?
 - 39% said no.
 - 5% said once / year.
 - 25% said twice / year.
 - ~15% willing to support unlocking/locking the gate.
 - 14% did not respond to this question, 2% said maybe they'd help.

The SLA Board informed the W&SD on 16 February 2024 that we would not be leasing the park. The SLA was informed that the W&SD may close the park again to manage fire concerns. Should you have any questions about the park's open status or use, please contact the W&SD (<https://sacheenlake.com/wsd-contacts/>) or attend one of their monthly meetings (<https://sacheenlake.com/water-sewer/>) in person.

Sacheen Lake WDFW Boat Ramp Extension

It appears that the WDFW boat ramp extension will not occur before the end of this June, which is the end of their current funding cycle. The latest from our WDFW Sacheen Lake manager, Daniel Dziekan, for the ramp extension is best expressed in terms of a quote from Daniel: "I submitted the project, again, to our Capital Project Request List. This project ranks at the top for our Region, it's going to happen it's just a matter of when. ... When I do hear about it you will be the first person to know."

Related to the ramp, if you check you will see that Google Maps has the boat ramp in the correct location! However, the tag on the ramp indicates it as "Sacheen Lake Public Access" without specifically calling it a boat ramp. For years people used to drive to Sacheen Southshore and try to launch their boats. Someone recently even placed a sign close to where the local owners store their boat trailers on Sacheen Southshore during the summer indicating that there was NOT a boat ramp there! Hopefully, the word will spread. For those contacting Google Maps to try to make changes to road names, etc., by your properties, Grant tried for years but had no success until he pointed them to the Pend Oreille County Property Search map!

2024 SLA and Community Involvement

The Board finalized the 2024 events calendar, and it is posted on our website:

<https://sacheenlake.com/sla-annual-calendars/>. We happily announced the photo calendar contest in a email sent on 10 January 2024. So, start snapping away! Photos this year must have been taken within the past two years. We'll also be holding the humorous Sacheen lake-life story again, to be announced later this spring. Our cleanup events specifically help us achieve the "clean use of the lake and surrounding ecosystems and their public access avenues" phrase of the SLA goals. They are also a good way to meet some community-minded neighbors, so come out and enjoy being a part of the lake community self-support efforts.

Sacheen Lake Association Calendar – 2024

Attendance at SLA Events requires signup and release of liability of the SLA

Event	Date and Time	Location
Myers-Harter Park Cleanup	Saturday, May 11, 2024, 8:00 am	Myers – Harter Park
Hwy 211 Cleanup	Saturday, May 25, 2024, 9:00 am	Meet at Myers – Harter Park
SLA Annual Meeting ²	Saturday, June 15, 2024, 9:00 am	Fire station on Hwy 211
Boat Launch Cleanup ¹	Saturday, June 22, 2024, 8:00 am	Meet at WDFW boat launch
Sacheen Community Annual Picnic ²	Saturday, July 6, 2024, 11:00 am	Myers – Harter Park
Fertile Valley Rd Cleanup	Saturday, July 20, 2024, 8:00 am	Meet at Myers – Harter Park
Hwy 211 Cleanup	Saturday, August 24, 2024, 9:00 am	Meet at Myers – Harter Park
Fertile Valley Rd Cleanup	Saturday, September 21, 2024, 8:00 am	Meet at Myers – Harter Park

1. Includes road cleanup from the intersection of Sacheen Terrace Dr and Hwy 211 to the WDFW gate for the boat launch area.
2. Signs to be put out 10 to 14 days prior to event by the lead.

Other* Sacheen Lake Community Events – 2024

Event	Date and Time	Location
4 th of July Boat Parade	Thursday, July 4, 2024, 2 pm	Section of the lake near the boat launch
Community Yard Sale**	Saturday, August 31, 2024, 9 am	Hwy 211 SPOFR Station
Photo Calendar Pickup	Saturday, Nov 9, 2024, TBD time	Hwy 211 SPOFR Station

* These events are not SLA sponsored / hosted events. However, the SLA uses our email system to help the community coordinate these events. The SLA is not liable for any injury or damage to any person or object during these events.

** Signs to be put out the day of the event

Website Updates

The SLA continues to update our public website (<https://sacheenlake.com/>), including a revamp of the Sacheen Water and Sewer Districts webpage posted on our website (<https://sacheenlake.com/water-sewer/>). We added tabs for our contest results and SLA merchandise and as shown below are working toward digitally posting the Welcome Packet. We believe these changes make navigation of the site easier, provides more information, education, and resource links, and increases our transparency to the community.

Website Greeting:

Sacheen Lake Association

Welcome Packet

The SLA resurrected the Welcome Packet in 2023 and this year it is being digitized and placed on our website. The current vision for the website posting is illustrated below.

Welcome Packet

The SLA provides this printable Welcome Packet to help newcomers to the community have information on the SLA, lake area safety, and local community locations. Please also see the [Resources](#) webpage with County, State, National, and Misc information links.

SLA-created Welcome Packet documents may be periodically updated. Commercially provided content not uploaded may be obtained from an SLA Board Neighborhood Area (NA) representative. ([NA Reps](#))

Provide feedback on the contents to: sacheenlake.assoc@gmail.com.

Sacheen Lake Association

- Welcome Letter from SLA President
- SLA And Community Events Calendar
- SLA Board Members
- Neighborhood Areas Representatives
- SacheenSCOPE Newsletter
- SLA Merchandise
- SLA Membership and Contact Form

Safety On and Around Sacheen Lake

- Safe Boating Laws
- SLA Placed Buoys and County No Wake Zones
- Dept of Licensing Boating and the Dangers of Carbon Monoxide
- Outdoor Burning on DNR-Protected Lands
- Wildfire...Are You Prepared?
- Pend Oreille Fire Safety Cooperative – Outdoor Fire Safety

Community Resources

- Spokane County Regional Solid Waste System
- Vendor Information
- Activity Information
- Protect the Night
- Sacheen Lake Waterfront Landscaping Questions and Answers

SLA Merchandise

The SLA is now posting (sort of quarterly) our current merchandise inventory (with photos, colors, sizes, etc.). Please see <https://sacheenlake.com/sla-merchandise/> for the most recent inventory listing. The pictures to the right capture some of the current inventory items and costs. Also, feel free to reach out to the Merchandise Program lead, Elaine Hooker, at sacheen.merch@gmail.com to make an order or check on the exact up-to-date inventory. As noted in the President's Message on page 1, the merchandise tracking program is up and running. Elaine has used this information and the results of her digital best-logo vote to assess the best-selling products and sizes and created a spring order for new merchandise using this trending analysis. The logo preference input from the community placed Option D at the top of list. The conversion to 21st Century technology is paying off!

SLA merchandise will be available for purchase at the following 2024 events:

- SLA Annual Meeting (6/15/2024)
- SLA Picnic (7/6/2024)
- Community Yard Sale (8/31/2024)
- 2025 Photo Calendar Pickup (11/9/2024)

Expired Logo Voting Form

Vote for your favorite new designs for Sacheen Lake merchandise



Scan the QR code or visit <https://forms.gle/bvYHawcUg9KfbEuz9>



OPTION A - WASHINGTON LOVE



OPTION B - LAKE LIFE



OPTION C - LAKE TOPOGRAPHY



OPTION D - FOREST GREEN HERON

DRINKWARE



Coffee Mugs \$5



Travel Tumblers \$30



Wine Glasses \$17



Koozies \$3

ACCESSORIES



Aprons - \$12, embroidered



Tote - \$17, printed



Stickers - \$2



Grocery Tote - \$12, embroidered

APPAREL

T Shirts - \$15-\$23 each



Turquoise - XS, S, M, XL
Yellow - XS, S, M, XL, XXL,
Sage - M, L

Female Red - S, M
Female Turquoise - S, M, L
Female Grey - L, M

Printed Heron



Female XL SportTek Embroidered Heron



Adult L Cotton Embroidered Heron



Adult L Cotton Embroidered Mountain

Information from the County Sheriff Webpage



Office of the Sheriff

Pend Oreille County, Washington



Glenn Blakeslee, Sheriff

The SLA queried the Sheriff Office's Marine Department to understand the nature of whether or not the public may be on someone's private dock. The following quote is from Sergeant Questin Youk:

"As a private dock owner, you are not required to allow general/public use of your dock. People can fish around your dock if they are in a boat, but that doesn't allow them to hop out on your dock and do what they want. The WA state regulation is WAC 332-30-144."

Some key quotes from WAC 332-30-144 follow.

(2) Eligibility. The permission shall apply only to the following:

(a) An "abutting residential owner," being the owner of record of property physically bordering on public aquatic land and either used for single family housing or for a multifamily residence not exceeding four units per lot.

(b) A "dock," being a securely anchored or fixed, open walkway structure visible to boaters and kept in good repair extending from the upland property, primarily used as an aid to boating by the abutting residential owner(s), and accommodating moorage by not more than four pleasure boats typical to the body of water on which the dock is located. Two or more abutting residential owners may install and maintain a single joint-use dock provided it meets all other design requirements of this section; is the only dock used by those owners; and that the dock fronts one of the owners' property.

(c) A "private recreational purpose," being a nonincome-producing, leisure-time, and discretionary use by the abutting residential owner(s).

(d) State-owned aquatic lands outside harbor areas designated by the harbor line commission.

(4) Limitations.

(c) The permission is limited to docks that conform to adopted shoreline master programs and other local ordinances.

(d) The permission is not a grant of exclusive use of public aquatic lands to the dock owner. It does not prohibit public use of any aquatic lands around or under the dock. Owners of docks located on state-owned tidelands or shorelands must provide a safe, convenient, and clearly available means of pedestrian access over, around, or under the dock at all tide levels. ***However, dock owners are not required to allow public use of their docks or access across private lands to state-owned aquatic lands.***

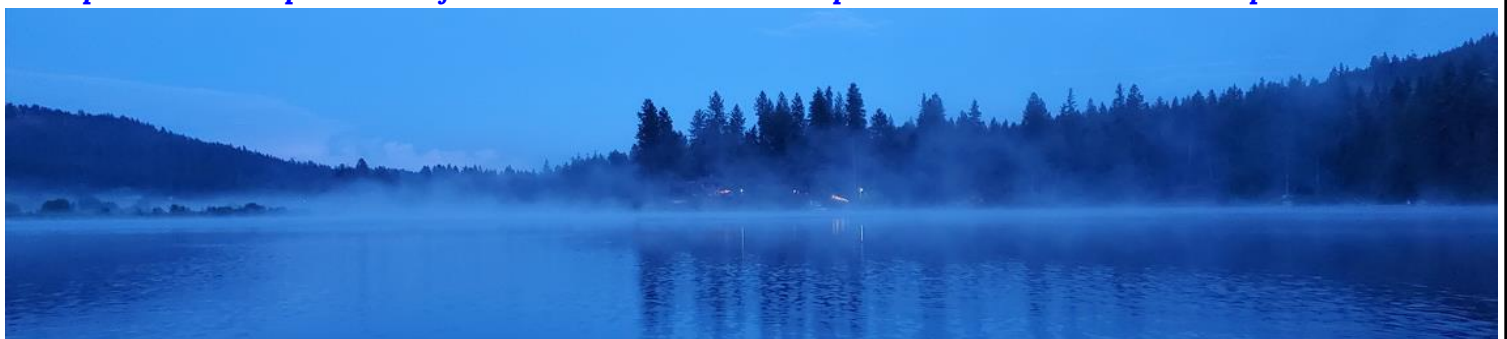

Meet Your Board

Role	Name	Phone	Neighborhood Area
President	Grant Miller	858 204 5560	NA 8
Vice President	Karlene Perry	509 869 8400	NA 4
Treasurer	Denise Reilly	509 954 5081	NA 1
Secretary	Connie Gross	509 550 5081	NA 3
Member	Lil Hastie	206 817 7562	At Large
Member	Beverly Schoen	509 714 0476	NA 6
Member	Joe Frauenheim	206 713 2395	At Large
Member	Anthony Patterson	509 217 2475	NA 2
Member	Carl Gross	509 550 5081	NA 5
Member	vacant		At Large
Member	vacant		NA 7 (supported by Grant for now)

Sacheen Lake Association



The SLA Board's NA assignments are revisited when new members join the Board

SLA Representative Neighborhood Areas (NA #)

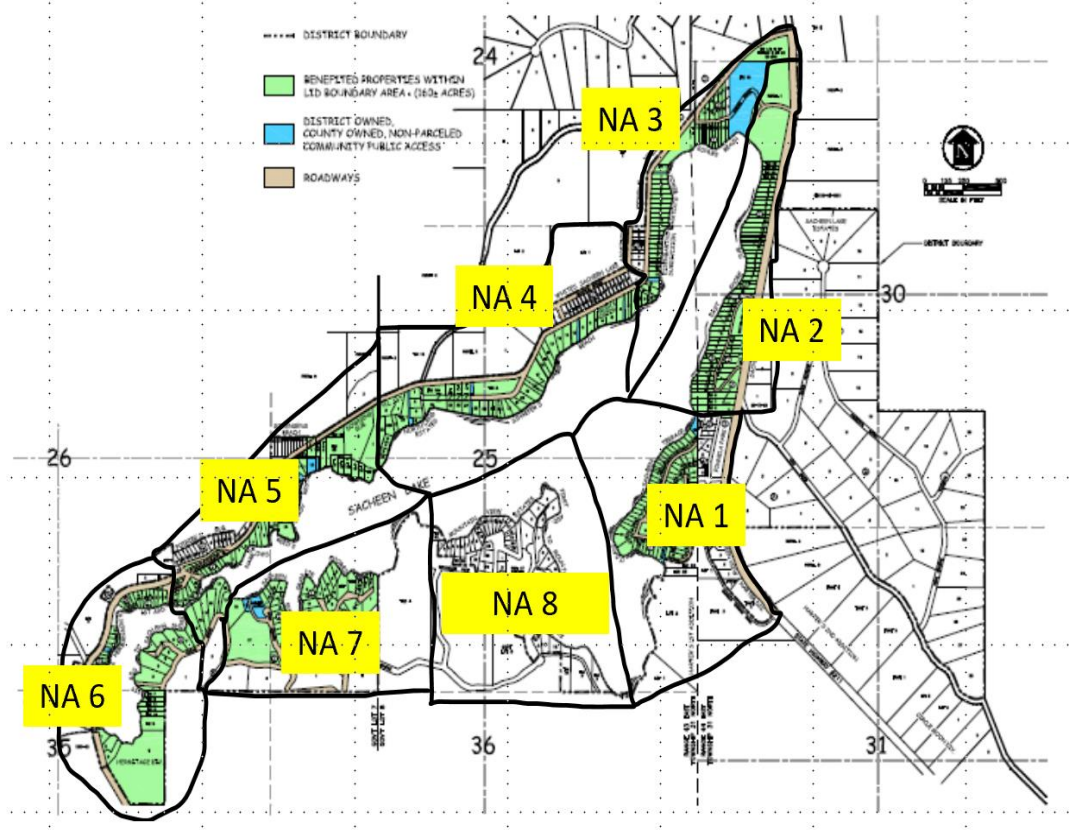

The SLA can be reached at: SacheenLake.Assoc@gmail.com

Treasurer dues queries and PayPal: Sacheen.Treasurer@gmail.com

Merchandise purchase request: Sacheen.Merch@gmail.com

www.sacheenlake.com

Don't forget to check out our website. It is a wonderful way to stay connected with our community, lake and sewer news, and the wildlife around the lake. To share your photos and info, contact Carl Gross at carlgross@gmail.com. All postings are approved by the SLA Board.

As a reminder, the SLA supports the finding and return of lost lake-oriented items of approximately \$50 or more through our email system. However, the best defense against losing an item on the lake is to ensure your items are secured!